

1.SHAPE AND DIMENSIONS(UNIT:mm)

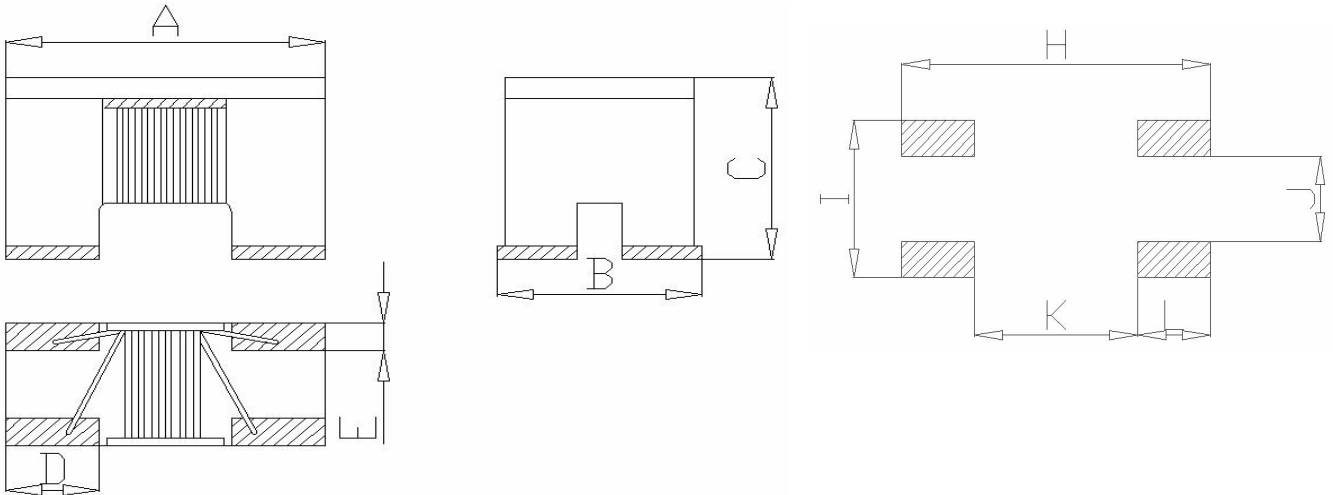

CRWCC 0805 S T 670 S □ □

(1) (2) (3) (4) (5) (6)

- (1)TYPE: 0204/0307/0410/0510
- (2)OUTSIDE DIAMETER
- (3)BODY LENGTH
- (4)PACKING: A(BOX) B(REEL)
- (5)INDUCTANCE
- (6)TOLERANCE: J=±5% K=±10% M=±20%

SIZE	Length(A)	Width(B)	High(C)	Terminal(D)	Terminal(E)
mm	mm	mm	mm	mm	mm
0805ST	2.00±0.10	1.20±0.10	1.20±0.10	0.45±0.10	0.40±0.10
1206ST	3.20±0.10	1.60±0.10	1.90±0.10	0.60±0.10	0.60±0.10

Introductions

The PWC series are wire wound common mode chokes widely used in notebooks,PC's,USB,HUB, and etc. The wire wound features advance in lower DC resistance and higher current tolerance, and much stable performance.

Features

- * Operating temperature - 40°C to +85°C
- * Excellent solderability and resistance to soldering heat
- * Suitable for flow and reflow soldering
- * Good dimensions, high reliability,and easy surface mount assembly.
- * Consisting of 0805 and 1206 sizes.



COMMON MODE WCC SERIES

SPECIFICATIONS OF 0805&1206 SERIES

PART NO.(0805&1206)	Impedance Ohm	Voltage V(DC)	Withstanding V(DC)	Current Max(Ma)	DC resistance MAX(ohm)	Insulation R(Min ohm)
0805SERIES						
CRWCC 0805 ST 670 S	67	50	125	400	0.25	10
CRWCC 0805 ST 900 S	90	50	125	330	0.35	10
CRWCC 0805 ST 121 S	120	50	125	370	0.30	10
CRWCC 0805 ST 181 S	180	50	125	330	0.35	10
CRWCC 0805 ST 261 S	260	50	125	300	0.40	10
CRWCC 0805 ST 361 S	360	50	125	280	0.45	10
1206SERIES						
CRWCC 1206 ST 900 S	90	50	125	370	0.30	10
CRWCC 1206 ST 161 S	160	50	125	340	0.40	10
CRWCC 1206 ST 261 S	260	50	125	310	0.50	10
CRWCC 1206 ST 601 S	600	50	125	260	0.80	10
CRWCC 1206 ST 102 S	1000	50	125	230	1.00	10
CRWCC 1206 ST 222 S	2200.00	50	125	200	1.20	10

1.Impedance is measured in HP4287A at frequency of 100MHZ.

2.For 15 Oc rise

CLIDER ENTERPRISE CO., LTD.